

SERVICE LETTER NO. 75-1  
"FAA DOA EA-4 APPROVED"  
SUPERSEDES SL 69-5 and SK-107

L  
E  
T  
T  
E  
R

DATE: February 3, 1975  
SUBJECT: IMPROVED ANTI-SHIMMY WASHER  
SERIALS AFFECTED: All Model AA-1 and AA-1A, AA1B-0001 thru AA1B-0523,  
AA5-0001 thru AA5-0746 and AA5B-0001 thru AA5B-0024.  
TIME OF COMPLIANCE: Anytime nose gear shimmy problems are experienced  
or sooner at owners discretion.

GENERAL

On some aircraft it has been noted that the tension on the nose fork anti-shimmy (Belleville) washers must be adjusted more often than normal to maintain the proper nose gear fork drag. If the drag is less than specified, side-to-side motion of the nose wheel and fork may occur; if the drag is greater than specified, increased brake pressure will be required to turn the aircraft, while taxiing.

To provide a stabilized drag between scheduled inspections, an improved anti-shimmy washer and a revised assembly sequence have been developed. This washer, identified as AM341615 Spring, may be used to replace the existing Belleville washers on the aircraft serials listed above. Refer to installation instructions for correct assembly sequence.

INSTALLATION INSTRUCTIONS (Refer to Figure 1)

N O T E

EARLY MODEL AA-1 AIRCRAFT ARE EQUIPPED WITH A SPRING PLUNGER THAT IS ATTACHED TO THE FORK TRAVEL STOP ON THE NOSE GEAR STRUT. IF INSTALLED, REMOVE AND DISCARD THE SPRING PLUNGER AND LOCK NUT, PRIOR TO INSTALLATION OF THE IMPROVED ANTI-SHIMMY WASHERS.

1. Remove weight from the nose landing gear per jacking instructions in the applicable service manual.
2. Remove MS24665-353 Cotter Pin and AN320-10 Nut that attaches nose fork to nose gear strut and discard existing Belleville and attach washers.
3. Assemble 702054-5 Washers, AM341615 Springs, AN960-1016L Washers and AN320-10 Nut in the order shown in Figure 1 and attach to nose gear strut.

N O T E

PRIOR TO INSTALLATION, APPLY GENERAL PURPOSE GREASE PER MIL-G-7711 BETWEEN RUBBING SURFACES OF WASHERS AND SPRINGS.

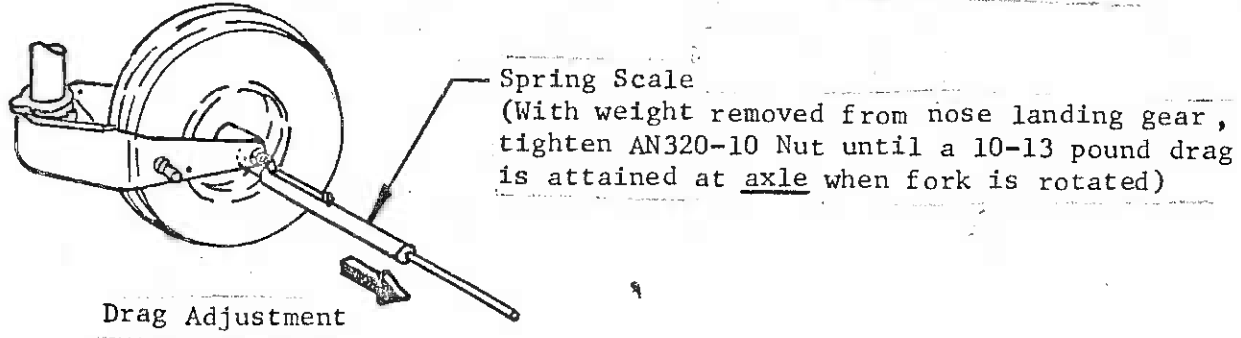
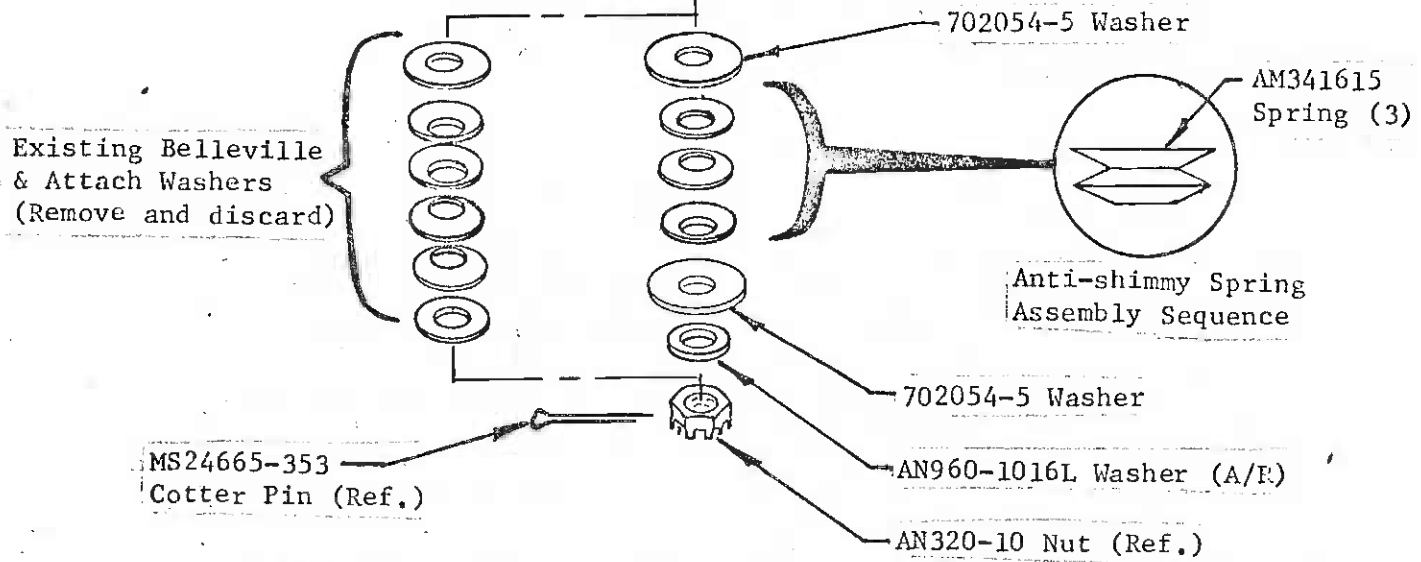
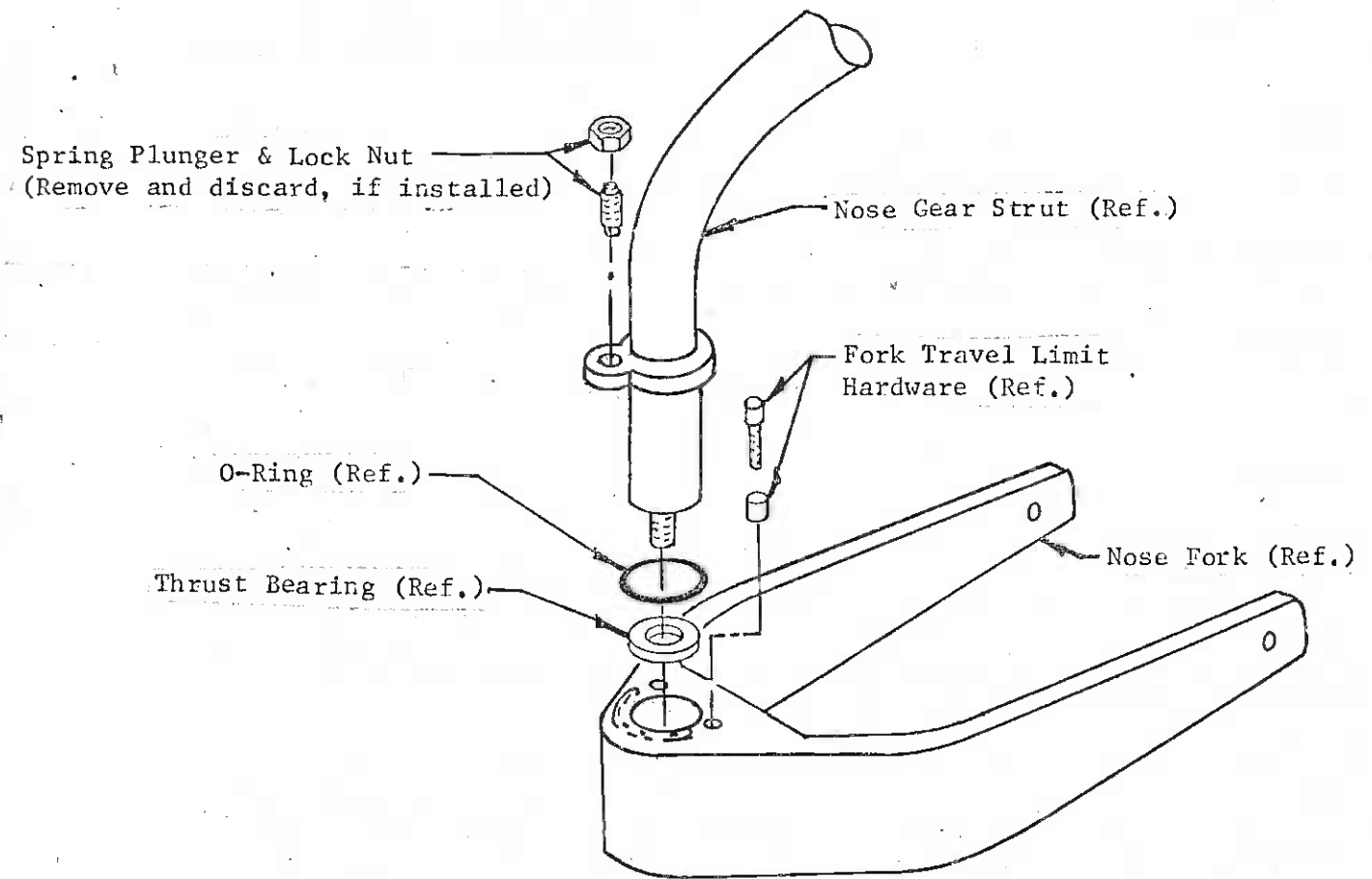

Figure 1. Improved Anti-shimmy Washer Test

4. Tighten AN320-10 Nut until a 10-13 pound drag is attained at axle when fork is rotated and install new MS24665-353 Cotter Pin.

## N O T E S

1. ADDITIONAL AN960-1016L WASHERS MAY BE ADDED TO INSURE THAT MS24665-353 COTTER PIN LOCKS AN320-10 NUT.
2. RECHECK DRAG AFTER INSTALLATION OF COTTER PIN, IF THE NUT WAS ADJUSTED TO ALLOW COTTER PIN INSERTION.

PARTS INFORMATION

<u>Quantity</u>	<u>Part Number</u>	<u>Description</u>	<u>Price Each</u>
2	702054-5	Washer	\$ .25 (H)
3	AM341615	Spring	.62 (H)
A/R	AN960-1016L	Washer	.04 (E)
1	AN320-10	Nut	.60 (E)
1	MS24665-353	Cotter Pin	.03 (E)

Parts required for the above installation are available from your authorized Grumman American Aviation Corporation Dealer.

Since the improved anti-shimmy washer is a design improvement, no parts or labor allowance will be available for compliance with this Service Letter.

The above information will be included in the next revision of each applicable service manual.

Price subject to change without notice.

Very truly yours,  
GRUMMAN AMERICAN AVIATION CORPORATION



Russ E. Belles  
Customer Service Manager

REB:nf

DISTRIBUTION (02)